

Project	Quantity	Item #
Model Specified:		CSI Section 11400

### Reach-In Refrigerators/Self-Contained



Model RHT132DUT



Models RHT132DUT & RHT232DUT



Models AHT132DUT & AHT232DUT

The R & A Series "DUT" Refrigerator Line is designed to offer maximum storage capacity within a two or four foot wide footprint. They are supplied standard with all the Traulsen top of the line features, such as balanced refrigeration systems, next generation INTELA-TRAUL® controls and stainless steel exteriors. Additionally, they offer the widest range of optional accessories, and can be modified for many different applications.

### Standard Features

- R-Series: Stainless Steel Exterior & Interior
- A-Series: Stainless Steel Exterior/Anodized Aluminum Interior
- Full Or Half Length Doors
- Self-Closing Doors With Stay Open Feature At 120 Degrees
- Guaranteed For Life Cam-Lift Hinges
- Guaranteed For Life Horizontal Work Flow Door Handle
- Automatically Activated Incandescent Lights
- Stainless Steel Breaker Caps
- Three Chrome Plated Adjustable Shelves Supported On Shelf Studs Per Section
- Automatic Non-Electric Condensate Evaporator
- Magnetic Snap-In Door Gaskets
- Cord & Plug Attached
- 6" Adjustable Stainless Steel Legs
- 1 Year Parts And Labor Warranty
- 5 Year Compressor Warranty

### The INTELA-TRAUL® Control System



#### KEY FEATURES

- 3-Digit LED Display
- Temperature Monitoring
- Internal Time Clock
- 72 Hour Data Storage
- °F or °C Temperature Display Capability
- Visual & Audible Alarm Warnings For:
  - (1) Hi/Lo Cabinet Temperature,
  - (2) Evaporator Coil Sensor Failure,
  - (3) Clogged Filter-Clean Condenser,
  - (4) Discharge Line Sensor Failure,
  - (5) Power Supply Interruption,
  - (6) Door Open (cycles and time)

#### PLEASE NOTE:

Two-Section models are available with left/right hinging only.

### Options & Accessories

- Heavy Duty 6" High Casters
- Stainless Steel Finished Back With Rear Louvers
- Additional Chrome Plated Shelves
- Hinged Glass Doors/Fluorescent Lights
- Export 220/50/1 Voltage
- Stainless Steel Shelves
- Decorative Kool Klad Decor
- Two Year Service/Labor Warranty Available



Listed by Underwriters Laboratories Inc., to U.S. and Canadian safety standards and Listed by NSF International.

Approval: \_\_\_\_\_



TRAULSEN & CO., INC.  
4401 BLUE MOUND RD.  
PHONE 1 (800) 825-8220  
Website: www.traulsen.com

FT. WORTH, TX 76106  
FAX-MKTG. 1 (817) 624-4302

SECTION  
1-4

Project	Quantity	Item #
Model Specified:		CSI Section 11400

## Specifications

### Construction, Hardware and Insulation

Cabinet exterior, including front, one piece sides, louver assembly and doors are constructed of heavy gauge stainless steel. Cabinet interior and door liners are constructed of stainless steel (anodized aluminum in the A-Series). Exterior cabinet top, back and bottom are constructed of heavy gauge aluminized steel. Adjustable 6" high stainless steel legs are included.

Doors are equipped with removable plug cylinder locks and guaranteed for life cam-lift, gravity action, self-closing metal, glide hinges with stay open feature at 120 degrees. Hinges include a switch to automatically activate the interior incandescent lighting. Guaranteed for life, work flow door handle is mounted horizontally over recess in door which limits protrusion from door face into aislaways.

Easily removable for cleaning, vinyl magnetic door gasket assures tight door seal. Anti condensate heaters are located behind each door opening.

Cabinet and door contains high density, non-CFC, foamed in place polyurethane insulation.

DIMENSIONAL DATA	R/AHT132DUT	R/AHT232DUT
Net Capacity cu. ft.	17.7 (501 cu l)	42.0 (1190 cu l)
Length Overall in.	24 (61.0 cm)	48 (121.9 cm)
Depth - Over Body in.	32 (81.3 cm)	32 (81.3 cm)
Depth - W/Door Open 90° in.	54 $\frac{3}{4}$ (139.1 cm)	54 $\frac{3}{4}$ (139.1 cm)
Depth - Overall in.	35 (88.8 cm)	35 (88.8 cm)
Clear Door Width in.	18 $\frac{5}{8}$ (47.3 cm)	19 $\frac{5}{8}$ (49.7 cm)
Clear Half Door Height in.	27 $\frac{1}{2}$ (69.9 cm)	27 $\frac{1}{2}$ (69.9 cm)
Clear Full Door Height in.	57 $\frac{5}{8}$ (146.3 cm)	57 $\frac{5}{8}$ (146.3 cm)
Number of shelves	3	6
Shelf area sq. ft.	14.2 (1.3 sq m)	31.6 (2.9 sq m)
Height - Overall in.	83 $\frac{1}{4}$ (211.5 cm)	83 $\frac{1}{4}$ (211.5 cm)

### ELECTRICAL DATA

Voltage	115/60/1	115/60/1
Feed Wires with Ground	3	3
Full Load Amperes	8.0	10.3
Wattage <sup>1</sup>	644	837

### REFRIGERATION DATA

Refrigerant	R-134a	R-134a
BTU/HR - HP <sup>2</sup>	2220 (1/3 HP)	4200 (1/2 HP)

### CARTON DIMENSIONS Domestic Crated Only

Length - Crated in.	35 (88.8 cm)	63 (160 cm)
Depth - Crated in.	43 (109.2 cm)	43 (109.2 cm)
Height - Crated in.	83 $\frac{1}{2}$ (212.1 cm)	83 $\frac{1}{2}$ (212.1 cm)
Volume - Crated cu. ft.	73 (2068 cu l)	131 (3711 cu l)

### WEIGHT DATA<sup>3</sup>

R Net Weight - Uncrated lbs.	330 (150 kg)	574 (260 kg)
R Gross Weight - Crated lbs.	420 (191 kg)	642 (291 kg)
A Net Weight - Uncrated lbs.	290 (132 kg)	446 (202 kg)
A Gross Weight - Crated lbs.	380 (172 kg)	573 (260 kg)

### NOTES

NOTE: Figures in parentheses reflect metric equivalents.

1=Wattage is determined by listed amps X listed volts X an average run time of 70% for refrigerators and 80% for freezers.

2=Based on a 90 degree F ambient and 20 degree F evaporator.

3=For approximate remote weights deduct 40 lbs. from respective net or gross weight. For other information on remote models, please refer to spec sheet 12-2.



Equipped With One NEMA 5-15 P Plug

### Refrigeration System

A top mounted, self-contained, balanced refrigeration system using R-134a refrigerant is conveniently located behind the one piece louver assembly. It features a plenum effect blower coil, large, high humidity evaporator coil located outside the food zone and a top mounted non-electric condensate evaporator. Standard operating temperature is 34 to 38°F.

### Controller

The water resistant INTELA-TRAUL® digital microprocessor control is provided. It includes an RS485 port for communications ability, in addition to features such as visual and audio alarms and 72 hour data storage capability.

### Interior

Standard interior arrangements include three (3) chrome plated wire shelves, mounted on shelf pins, per section. Recommended load limit per shelf should not exceed 225 lbs.

### Warranties

The standard warranty includes a five year compressor warranty and a one year parts and labor warranty on all components and the cabinet. Additional warranties are available at extra cost. The INTELA-TRAUL® Control is warranted by a two year parts and labor warranty.

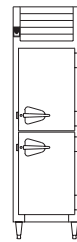

Elevation -  
R/AHT132DUT

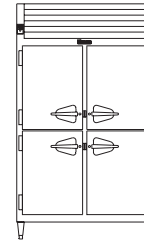

Elevation -  
R/AHT232DUT

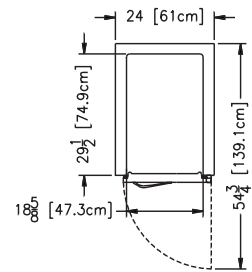

Plan - R/AHT132DUT

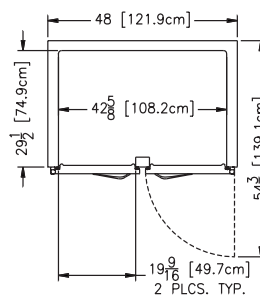

Plan - R/AHT232DUT

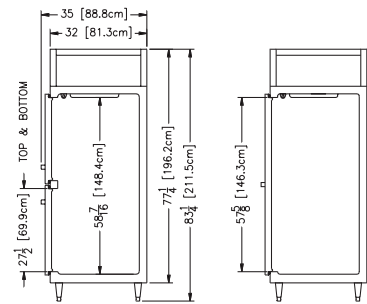

Section - All Models

Full load amps and plug style may vary depending on electrical options chosen and condensing unit employed.

**NOTE: Freight charges are FOB destination for dock to dock delivery within the continental USA. Liftgate delivery charges are additional. For inside delivery charges, please consult factory.**

Continued product development may necessitate specification changes without notice.  
Part No. TR-210 (revised 1/03)

SECTION  
1-4

TRAULSEN & CO., INC.  
4401 BLUE MOUND RD.  
PHONE 1 (800) 825-8220  
Website: www.traulsen.com

FT. WORTH, TX 76106  
FAX-MKTG. 1 (817) 624-4302

**Traulsen**