



SAVAGE
BROS. CO.
SINCE 1855

A 21st Century Company . . . with 19th Century Craftsmanship

1125 Lunt Avenue
Elk Grove Village, IL 60007-5023 USA



Phone: 847-981-3000
USA Fax: 800-2-SAVAGE
World Fax: +847-981-3010

E-mail: info@savagebros.com
Web: www.savagebros.com

ElectroStove-20 Candy Stove

Simple to operate and incredibly efficient

Just plug it in, set the variable heat control, and turn out a perfect batch, time after time. All of our electric stoves feature:

- Unique coiled heating system embedded in an insulation mantle shaped to fit the contour of the kettle.
- A focused heating design to move 90% of the heat energy to the kettle.
- Stainless steel construction
- Special ventilation is not required
- Will not heat up your kitchen
- ETL certified to UL electric standards
- ETL certified to NSF sanitation standards when used with a stainless steel kettle



Heating Element with Kettle Ring



Both Copper and Stainless Steel 20" diameter Kettles can be used!



Shown with Stove mounted Digital Temperature Control Option.
Best kettle size: 20" diameter x 11" deep.

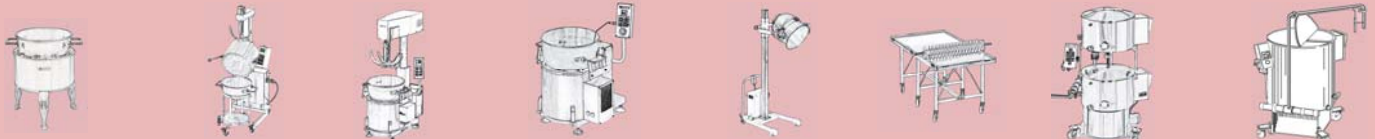

Gas & Electric Stoves ♦ Copper & Stainless Kettles ♦ FireMixer Cooker-Mixers ♦ Hi-Speed Cookers ♦ Bowl & Kettle Lift/Trucks ♦ Cooling Tables ♦ Chocolate Tempering ♦ Depositing & Transfer Systems

ElectroStove-20

ETL Certified to UL Electric Standards &
NSF Sanitation Standards (when used with a stainless steel kettle)

	Model #0100	Model #0101	Model #0105	Model #0106
Electric: Voltage 50/60Hz	220-240 Volts	208 Volts	220-240 Volts	208 Volts
Phase	3-Phase	3-Phase	1-Phase	1-Phase
Amperage	20	20	33	34
Maximum Output	7.2 KW	6.9 KW	7.2 KW	6.9 KW
The Following items apply to all 4 models shown above:				
Batch Temperature Range	180 – 360 degrees Fahrenheit / 80 – 180 degrees Celsius			
Dimensions: Height	26 in / 66 cm			
Outer Diameter	23 in / 58 cm			
Kettle Size: Best	20" x 11" in (11gal) / 500 x 290 mm (41.8 L)			
Maximum	20" x 16" / 500 x 400 mm			

Simple Controls



Add Optional Temperature Control with Sensor Probe to create a COOKER with set-point alarm and automatic OFF/ON heat control

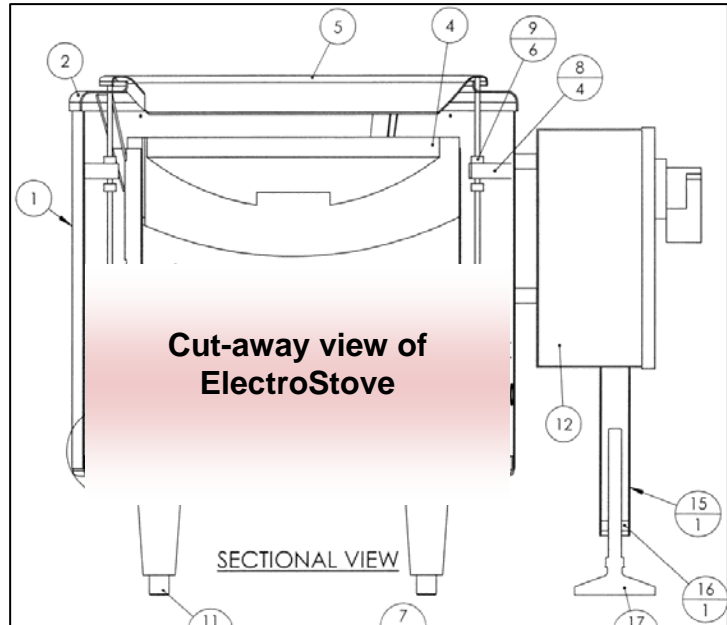

- 1) Stainless Steel outer shell 4) Heating Element
5) ElectroStove Dish 12) Control Box 17) Leveling foot

Would you like an electric cooker, but this model is not quite the right size?

Ask to see our Table-Top Cooker, or full featured S-92 Electric FireMixer.



SAVAGE
BROS. CO.
SINCE 1855